



Golden Sierra

REQUEST FOR QUOTE

DATE: October 11, 2017

Golden Sierra Job Training Agency is a government agency providing employment and training services to the Placer County area. We are seeking bids for dismantling transport and assembly of existing office cubicles.

Please supply quote based on the following features and specs below.

- Dismantle 7 single & 2 double cubicles in Auburn, CA
 - Transport to Roseville, CA
 - Assemble 8 single cubicles in Roseville, CA.
- They all include:

- Overhead with light
- Shelf with light
- 2 drawer filing cabinet
- 3 smaller drawers on the opposite side

* All specifications might be subject to change

[Floor plan attached]

Quotes must include the following:

- Cost to:
 - Dismantle 7 (6x7) & 2 (6x14) workstations in Auburn.
 - Transport, labor and equipment needed.
 - Install 8 (6x7) workstations in Roseville.
- Approximate time it would take to complete the work.
- Provide cost for business hours and after business hours.

* Bid at prevailing wage if over \$1,000

Location of Service 115 Ascot Drive
Suite 100
Roseville, CA 95661

Questions

Questions regarding the RFQ and/or the submission process must be submitted in writing to Carline Chavez @ chavez@goldensierra.com. All questions must be submitted no later than **October 18, 5:00 pm**. To ensure a fair and objective evaluation, answers to all questions will be posted at rfp.goldensierra.com.

Submission instructions

All bids submitted by mail or fax must be signed and dated. **All mailed or faxed bids not signed and dated will not be accepted.** Bids must be submitted by mail, fax, or email to:

Golden Sierra Job Training Agency
1919 Grass Valley Hwy, Suite 100
Auburn, CA 95603
Fax: (530) 885-5579
Email: chavez@goldensierra.com

All bids **must** be received by (not postmarked):

Wednesday October 25, 2017 – 5:00 p.m.

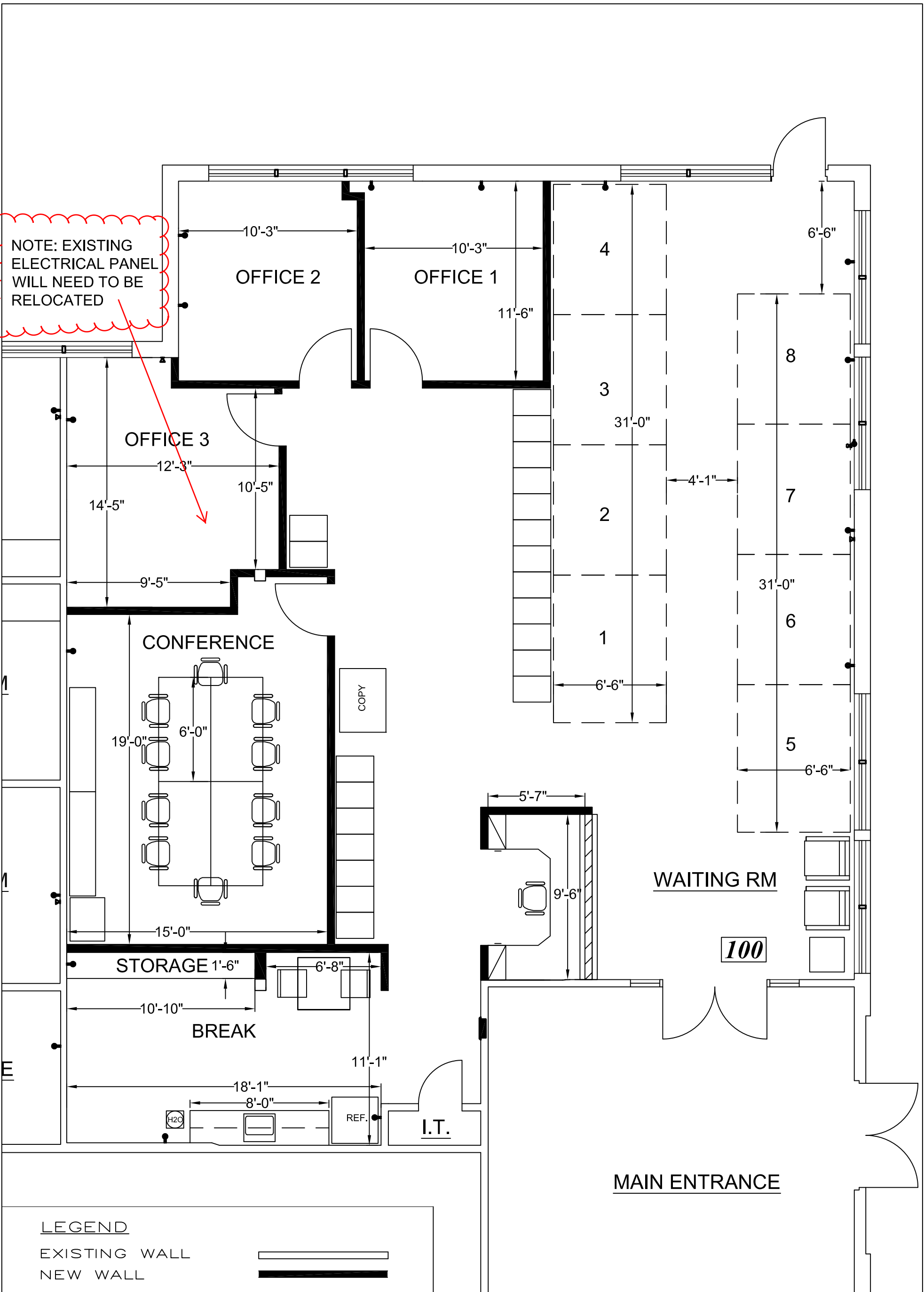

CDG
 CORPORATE DESIGN GROUP, INC.
 2150 Douglas Boulevard Suite 225
 Roseville, CA 95661
 (916) 781-6543

DRAFT

KIDDER MATHEWS
 115 ASCOT DRIVE
 SUITE 100
 OPTION 4

Date: 11/18/16 Scale: NOT TO SCALE